

# FL500

REVISIONS							
ZONE	REV	ECR	DESCRIPTION	BY	DATE	APPR DATE	
-	0	800000027815	PRODUCTION RELEASE	WJE	12JUN18	BM	20JUN18

**Sensitivity**  
 1 (Std) 100%  
 2 75%  
 3 50%

**Time Delay**  
 1 2 SECOND DELAY  
 2 4 SECOND DELAY  
 3 8 SECOND DELAY  
 4 (STD) 10 SECOND DELAY

**Housing**  
 1 (Std) STAINLESS STEEL

**Cable Entry**  
 1 (Std) 2x3/4" NPT  
 2 2x25mm

**Approvals**  
 1 (Std) FM/CSA/ATEX/IECEx

**Mounting Bracket**  
 0 Without Bracket  
 1 (STD) With Bracket (p/n 71370-1)

**RELAY STATE - NC**  
 1 LATCH ALARM/NON-LATCH WARN DE-ENERGIZED NO CHARGE  
 2 LATCH ALARM/NON-LATCH WARN ENERGIZED NO CHARGE  
 3 LATCH ALARM/LATCH WARN DE-ENERGIZED NO CHARGE  
 4 LATCH ALARM/LATCH WARN ENERGIZED NO CHARGE  
 5 (Std) NON-LATCH ALARM/NON-LATCH WARN DE-ENERGIZED NO CHARGE  
 6 NON-LATCH ALARM/NON-LATCH WARN ENERGIZED NO CHARGE  
 7 NON-LATCH ALARM/LATCH WARN DE-ENERGIZED NO CHARGE  
 8 NON-LATCH ALARM/LATCH WARN ENERGIZED

**Alarm Output**  
 1 4-20mA SOURCE CURRENT, RELAYS, SINGLE MODBUS, HART off  
 2 4-20mA SINK CURRENT, RELAYS, SINGLE MODBUS, HART off  
 3 (Std) 3.5 mA HART, SOURCE CURRENT, RELAYS, SINGLE MODBUS  
 4 3.5 mA HART, SINK CURRENT, RELAYS, SINGLE MODBUS  
 5 1.25 mA HART, SOURCE CURRENT, RELAYS, SINGLE MODBUS  
 6 1.25 mA HART, SINK CURRENT, RELAYS, SINGLE MODBUS

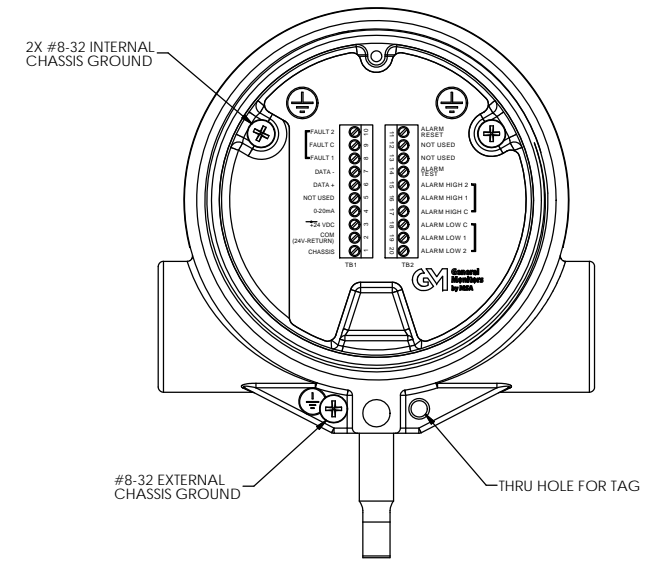
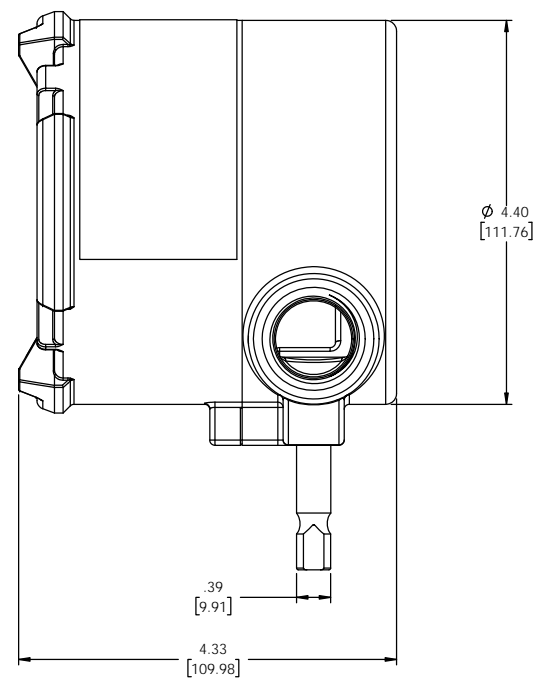
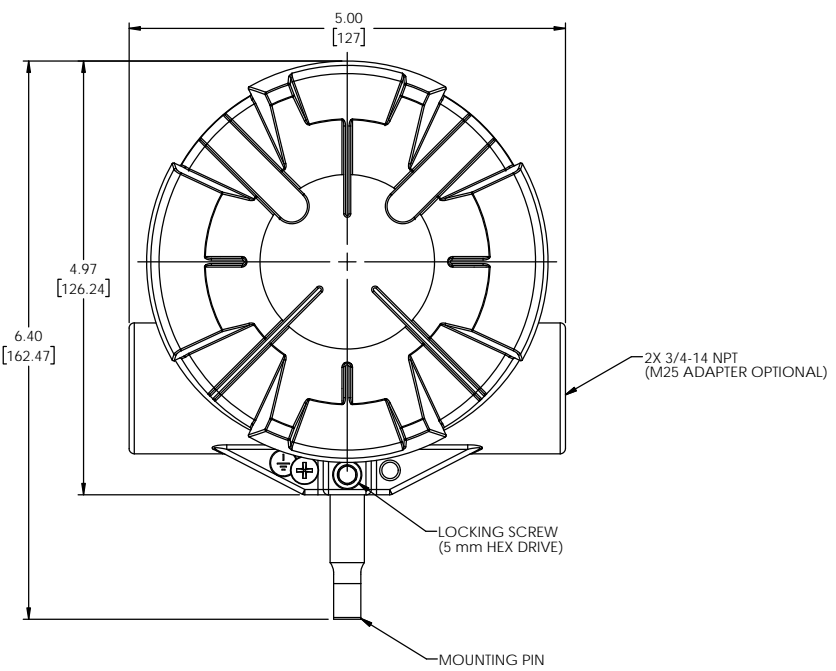

3. ENCLOSURE FINISH:  
 - STAINLESS STEEL PASSIVATED, RED POLYESTER (TGIC) POWDER COAT

2. DETECTOR WEIGHT:  
 - STAINLESS STEEL ENCLOSURE: 9.4 lb [4.3 kg]

1. DIMENSIONS ARE FOR REFERENCE ONLY.

NOTES: UNLESS OTHERWISE SPECIFIED

UNLESS OTHERWISE SPECIFIED		THIRD ANGLE PROJECTION		The information and technical data disclosed by this document may be used and disseminated only for the purposes and to the extent specifically authorized by General Monitors, Inc. in writing. Such information and technical data are proprietary to General Monitors, Inc. and may not be used or disseminated except as provided in the foregoing sentence.	
DRAWN	WJE	03MAY18	CHK'D	L.VLAGEA	02MAY18
DIMENSIONS	INCH[mm]	ENGR	B.MONAHAN	02MAY18	
CUSTOMER	_____				
P.O. NO.	_____				
GM NO.	_____				
LOCATION	_____				
TAG NO.	_____				
TOTAL NO. OF UNITS	_____				
DRAWING NO.: 712906		LIFECYCLE STATE: Production		REV: 0	
SCALE: NTS	MODEL: FL500	SHEET 1 OF 2			

**GM General Monitors by MSA** LAKE FOREST, CA, USA GALWAY, IRELAND

TITLE: **INSTALLATION OUTLINE DRAWING, FL500**

712907	712902
NEXT ASSY	USED ON

WIRING			
POSITION	TB1	POSITION	TB2
10	FAULT 2	11	ALARM RESET
9	FAULT C	12	NOT USED
8	FAULT 1	13	NOT USED
7	DATA-	14	ALARM TEST
6	DATA+	15	ALARM HIGH 2
5	NOT USED	16	ALARM HIGH 1
4	0-20 mA	17	ALARM HIGH C
3	+24VDC	18	ALARM LOW C
2	COM (24V-RETURN)	19	ALARM LOW 1
1	CHASSIS	20	ALARM LOW 2

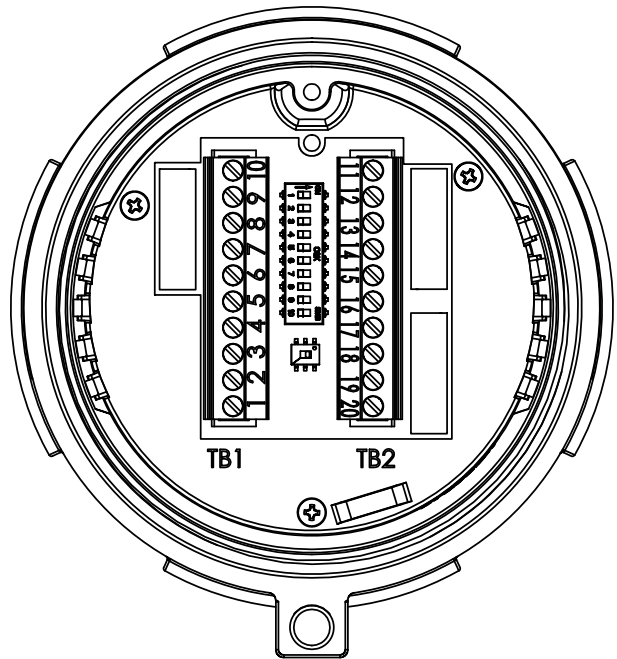

MAXIMUM WIRE LENGTH TO INSTRUMENT FOR A +24 VDC SUPPLY (MAXIMUM 20 OHM LOOP)

AWG	mm <sup>2</sup>	Feet	Meters
14	2.08	6588	2013
16	1.31	4146	1266
18	0.823	2608	796
20	0.519	1642	501
22	0.33	1055	321

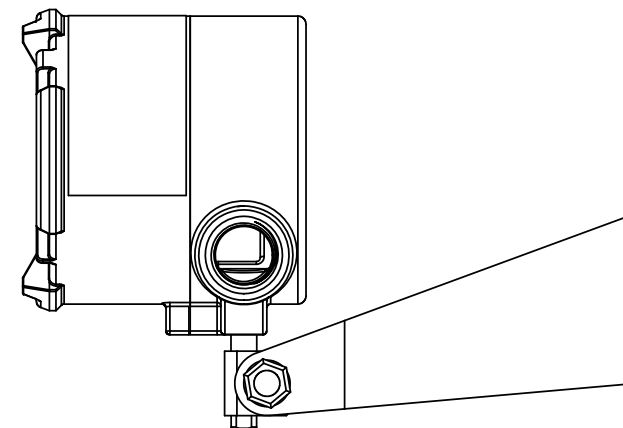
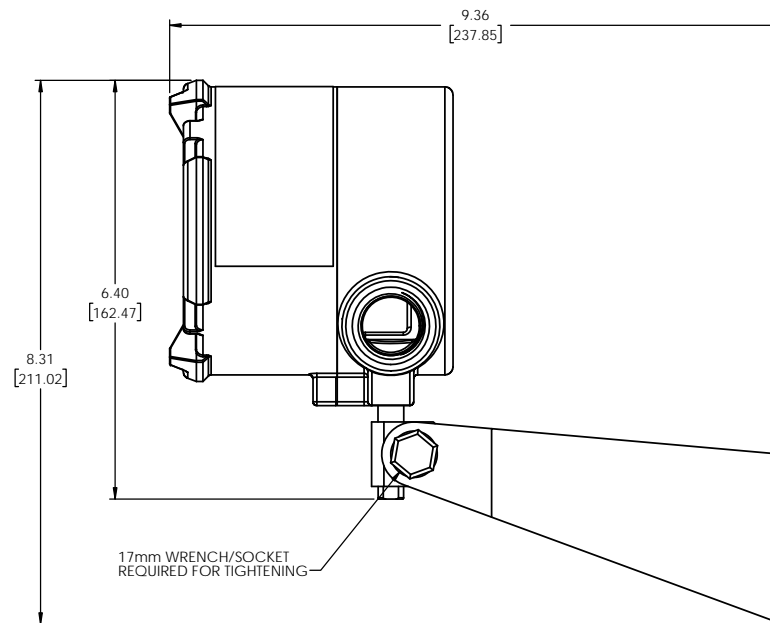
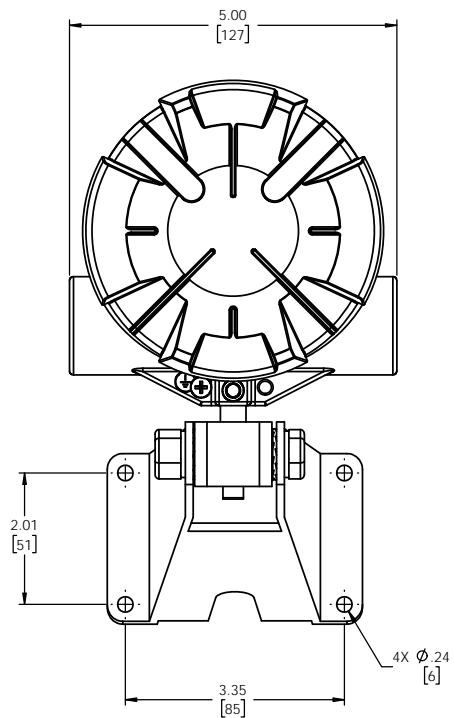

**GM** General Monitors by MSA  
LAKE FOREST, CA, USA  
GALWAY, IRELAND

The information and technical data disclosed by this document may be used and disseminated only for the purposes and to the extent specifically authorized by General Monitors, Inc. in writing. Such information and technical data are proprietary to General Monitors, Inc. and may not be used or disseminated except as provided in the foregoing sentence.

DRAWING NO.: 712906 LIFECYCLE STATE: Production REV: 0  
SCALE: NTS MODEL: FL500 SHEET 2 OF 2